

PRODUCT FEATURES

TRILIGHT is a certified and CE compliant façade system.





trilignt

| | PC216 | ARCOPLUS 625 | PC 540-3 | PC 540-7 | PC 560-11 |
|--|------------------------|-----------------|----------------|----------|-----------|
| COVERED WIDTH (mm) | 200 | 667 | 500 | 500 | 500 |
| DIMENSIONS (mm) | 210 X 16 | 683 X 20 | 525 X 40 | 252 X 40 | 525 X 60 |
| U-VALUE (W/m ² K) | 2,7 | 1,7 | 1,7 | 1,1 | 0,80/0,82 |
| SOUND ABSORPTION APPROX. (dB)DIN52210 | 16 | 16 | 21 | 21 | 22 |
| COLOR RANGE (STANDARD) | CRISTALL, BRONZE, OPAL | | CRISTALL, OPAL | | |
| LIGHT TRANSMISSION (%) | 65-35 | 60-35 | 58-30 | 56-30 | 54-28 |
| FIRE RATING (EN ISO 1350-1-1) | | | B-S1, D0 | | |
| CE CLASSIFICATION | + | + | + | + | + |

**WALL GLAZING INTO
OPENING NOT THERMALLY
BROKEN 40 mm PANELS**

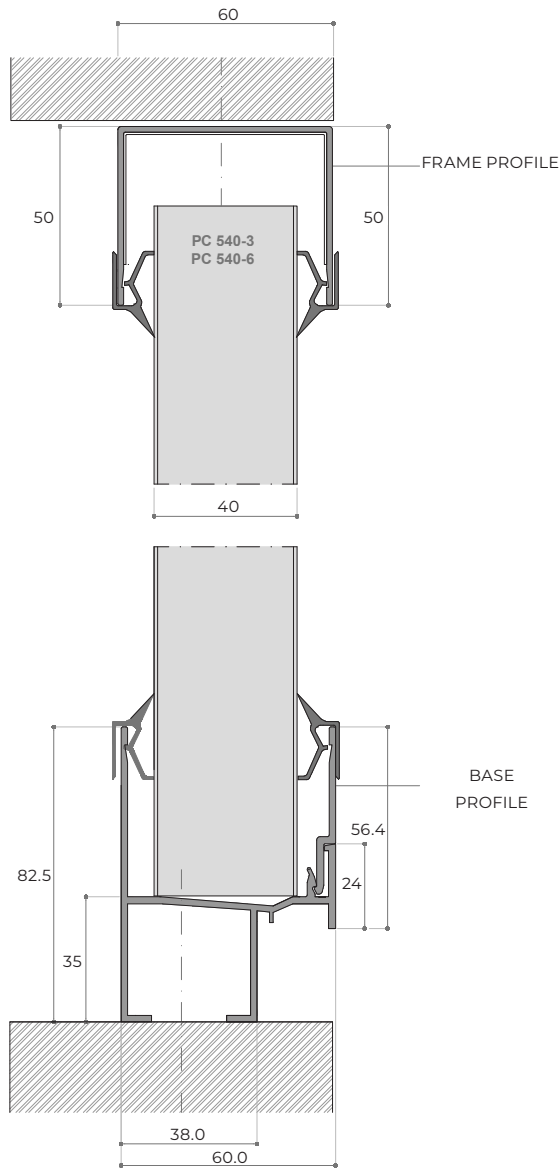

**WALL GLAZING FACE MOUNTED
40 mm PANELS**

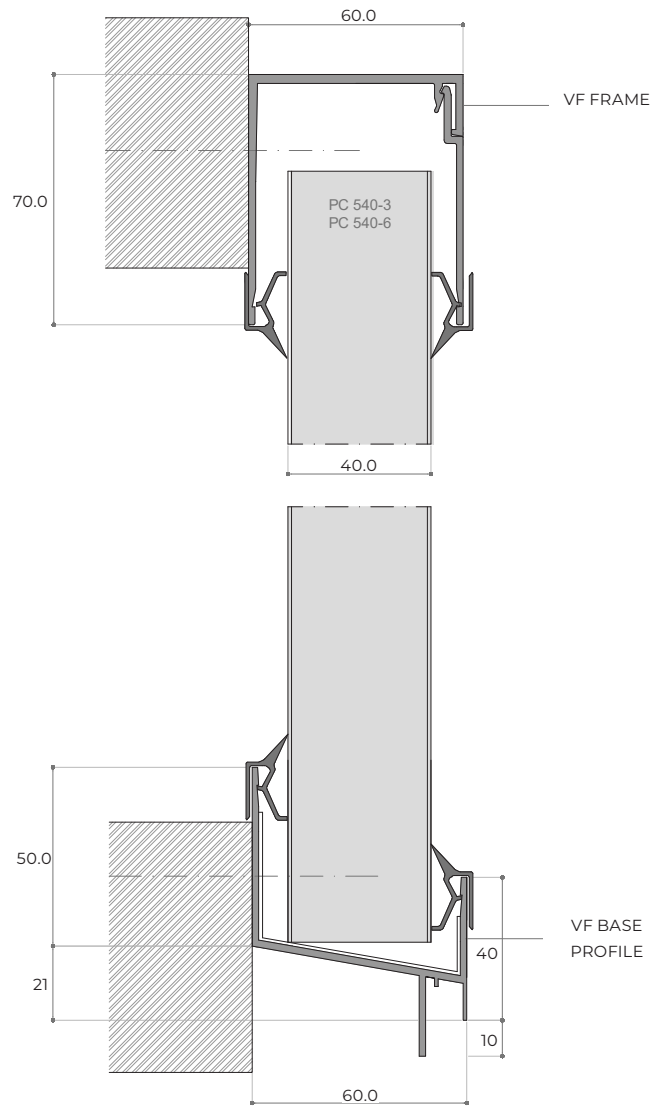

PC 216

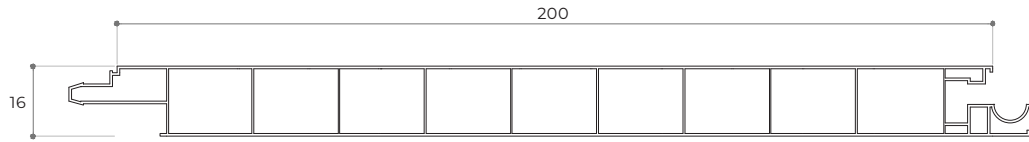

PC 560-11

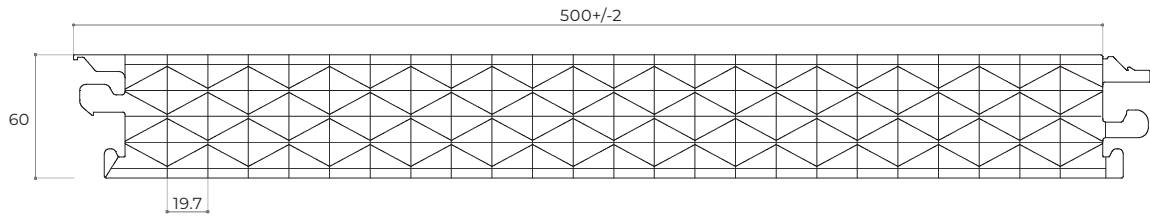

PC 540-3

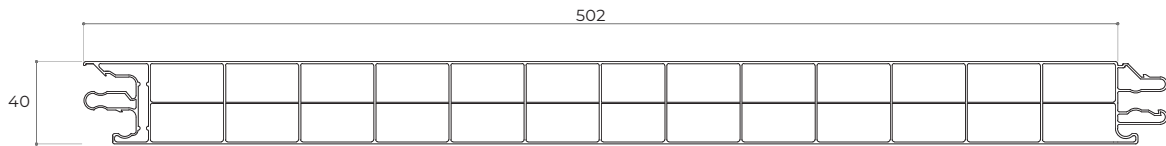

PC 540-7

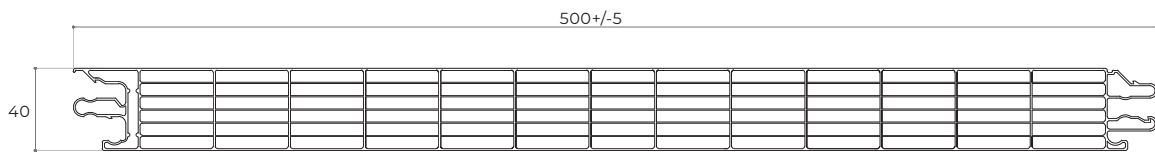

ARCOPLUS 625

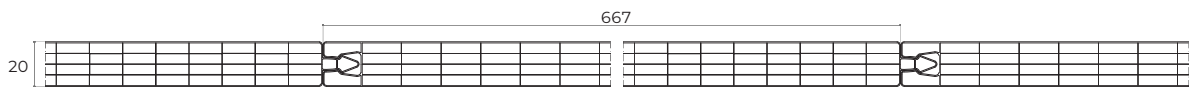

**WALL GLAZING THERMALLY
BROKEN 60 mm PANELS**

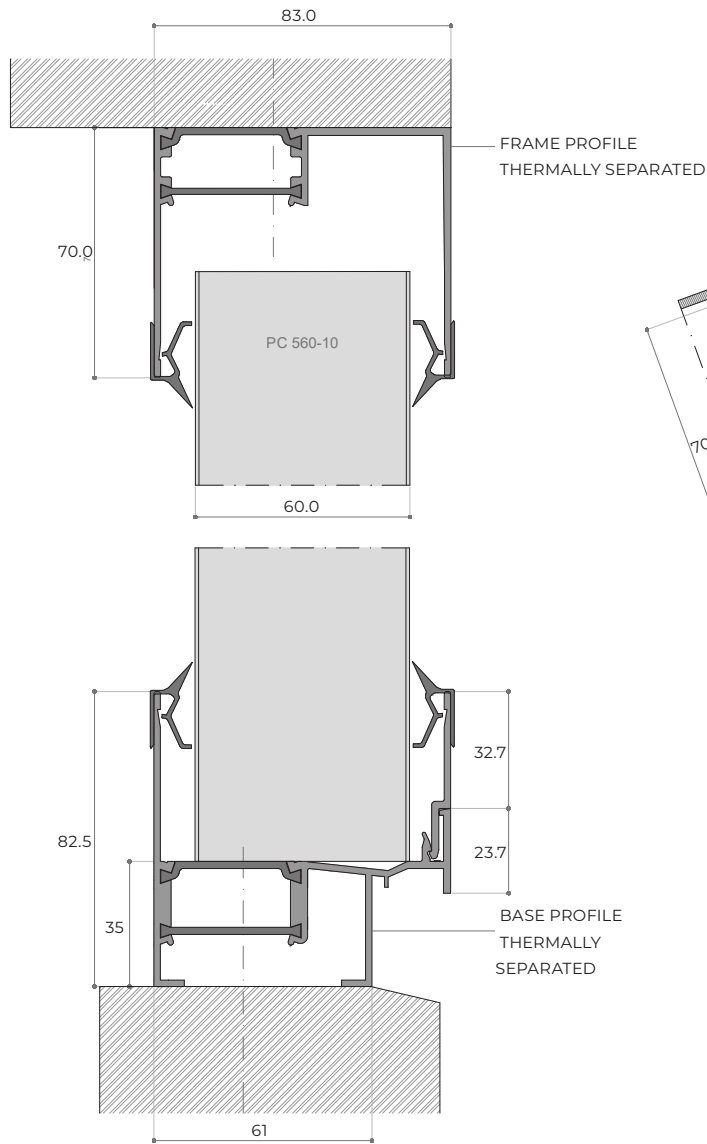

ROOF GLAZING > 25°SLOPE

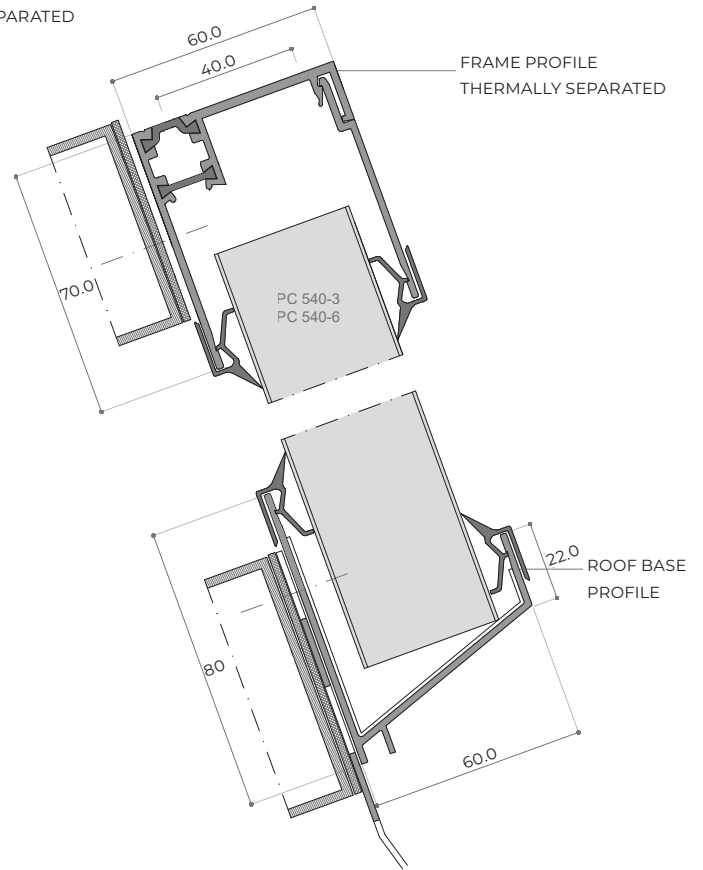

**ALUMINIUM H-BAR
40 mm PANELS**

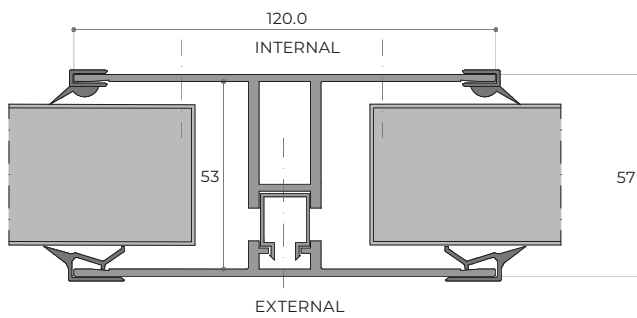

ALUMINIUM PURLIN CLIP

